

SUMMARY OF CONCRETE DRIVEWAYS

| STATION | WIDTH 'W' (FT.) | DIMENSION 'C' (FT.) | DIMENSION 'S' (FT.) | DIMENSION 'B' (FT.) | DIMENSION 'A' (FT.) | DRIVEWAY (CONCRETE) (SY) | DRIVEWAY (CONCRETE) (PRIVATE) (SY) |
|---------------|--------------------|------------------------|------------------------|------------------------|------------------------|--------------------------------|--|
| | | | | | | | |
| | | | | | | | |
| | | | | | | | |
| | | | | | | | |
| | | | | | | | |
| | | | | | | | |
| | | | | | | | |
| | | | | | | | |
| | | | | | | | |
| | | | | | | | |
| | | | | | | | |
| | | | | | | | |
| | | | | | | | |
| | | | | | | | |
| | | | | | | | |
| | | | | | | | |
| TOTALS | | | | | | | |

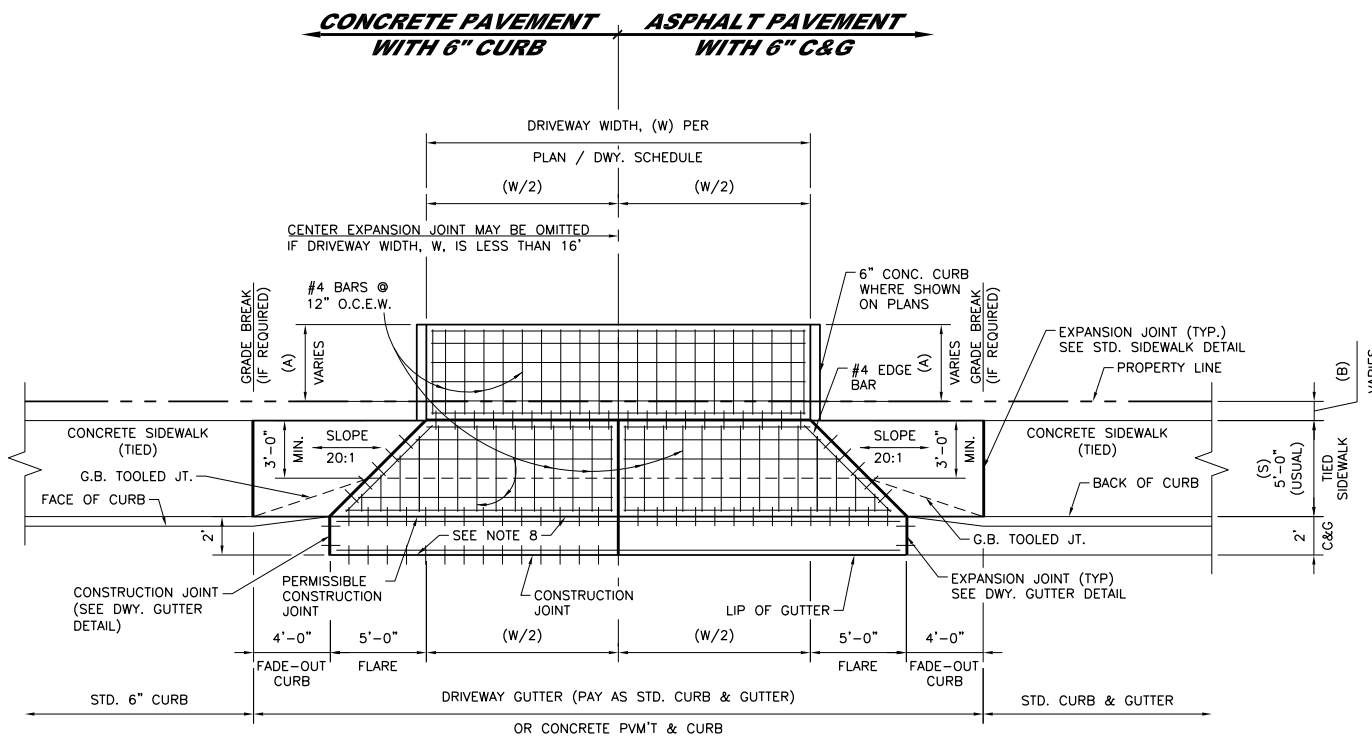

PLAN
DRIVEWAY WITH TIED SIDEWALK
NOT TO SCALE

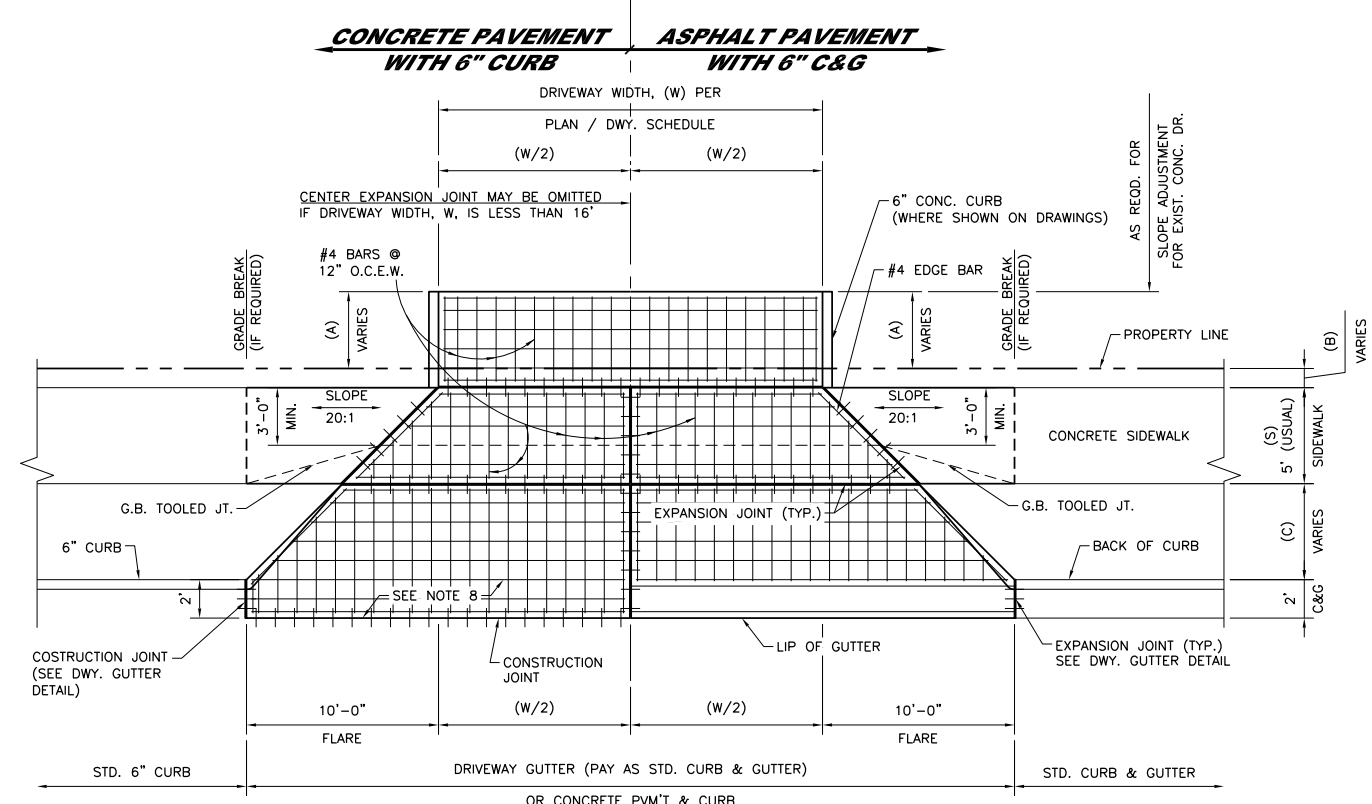

PLAN
DRIVEWAY WITH DETACHED SIDEWALK
NOT TO SCALE

- DRIVEWAY NOTES:**
- GRADES FOR WALKWAY AREAS WITHIN DRIVEWAYS SHALL NOT EXCEED 20:1 ALONG THE DIRECTION OF PEDESTRIAN TRAVEL, LONGITUDINAL, EITHER WITHIN THE DRIVEWAY OR AT THE SIDEWALK APPROACHES ABUTTING THE DRIVEWAY. CROSS-SLOPE, TRANSVERSE SLOPE, OF WALKWAY SHALL NOT EXCEED 50:1.
 - DRIVEWAY SLOPE SHALL NOT EXCEED 10:1, EXCEPT UNDER SPECIAL CIRCUMSTANCES, IF AUTHORIZED BY THE ENGINEER.
 - CONCRETE FOR DRIVEWAYS SHALL BE CLASS "A" AND HAVE A MINIMUM THICKNESS OF 6 INCHES.
 - RE-BAR SHALL BE GRADE 60, WITH A MAXIMUM SPACING OF 12" C-C AND ADDITIONAL DIAGONAL BARS AS SHOWN.
 - EXPANSION JOINTS SHALL BE OF 3/4" REDWOOD EXPANSION BOARD AND DOWELS SHALL BE GREASED, 12 INCHES LONG, SMOOTH #4 BARS WITH ONE END BEING FELT WRAPPED. CONTINUOUS BARS SHALL NOT EXTEND THROUGH THE EXPANSION JOINT, BUT SHALL TYPICALLY STOP 3 INCHES CLEAR OF EXPANSION JOINT.
 - MIDDLE EXPANSION JOINT SHALL BE USED, IF THE DRIVEWAY WIDTH, W, IS 16 FEET OR WIDER. THE EXPANSION JOINT SHALL EXTEND FROM THE BACK OF WALKWAY TO THE LIP OF CURB.
 - FINAL ACCEPTANCE OF THE PROJECT SHALL BE CONTINGENT UPON THE CONTRACTOR PROVIDING THE CITY WITH A CERTIFICATION LETTER FROM THE TEXAS DEPARTMENT OF LICENSING AND REGULATION (TDLR), POLICY AND STANDARDS DIVISION, ARCHITECTURAL BARRIERS SECTION, THAT ALL ADA (AMERICANS WITH DISABILITIES ACT) HANDICAP IMPROVEMENTS, AS CONSTRUCTED, COMPLY WITH THE TEXAS ACCESSIBILITY STANDARDS (TAS) OF THE ARCHITECTURAL BARRIERS ACT ARTICLE 9102, TEXAS CIVIL STATUTES.
 - THE 2' CUTOUT DOES NOT APPLY TO NEW DRIVEWAYS CONSTRUCTED ON EXISTING CONCRETE ROADWAYS. CONTRACTOR SHALL DRILL AND EPOXY #4 x 12" DOWELS @ 12" O.C. TO CONNECT DRIVEWAY TO EXISTING CONCRETE ROADWAY.

SPECIAL NOTE:
THE EXACT TYPE OF DRIVEWAY TO BE DETERMINED BY THE ENGINEER, BASED ON EXIST. CONDITIONS.

| REVISION NO. | DATE | BY | DESCRIPTION |
|--------------|------|----|-------------|
| | | | |
| | | | |

SHEET _____ of _____
RECORD DRAWING NO. _____
CITY PROJECT # _____

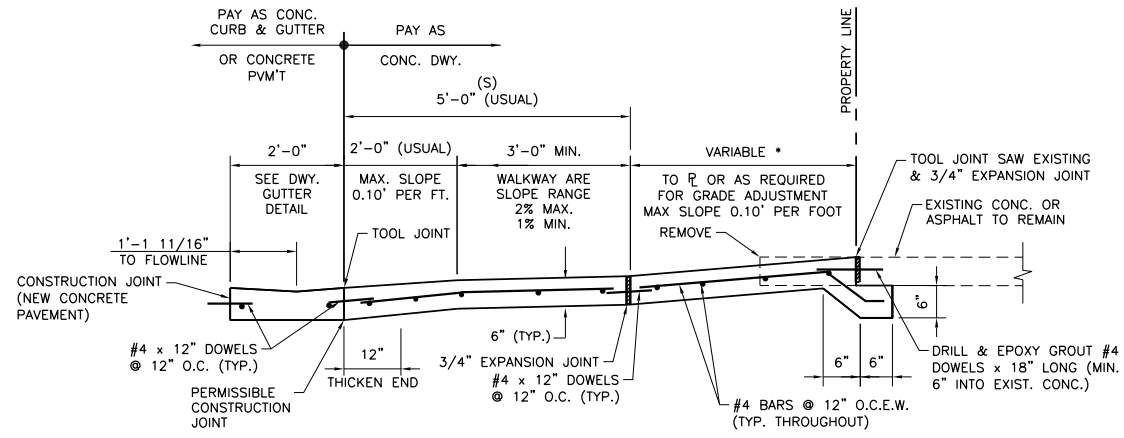

**SECTION
DRIVEWAY WITH TIED SIDEWALK**

NOT TO SCALE

* DRIVEWAY IMPROVEMENTS MAY NEED TO EXTEND INTO PRIVATE PROPERTY TO ACHIEVE 10% MAXIMUM SLOPE.

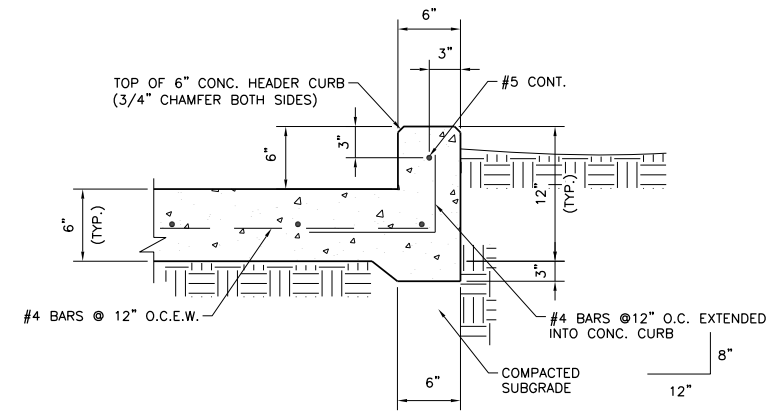

TYP. DRIVEWAY HEADER CURB DETAIL

NOT TO SCALE

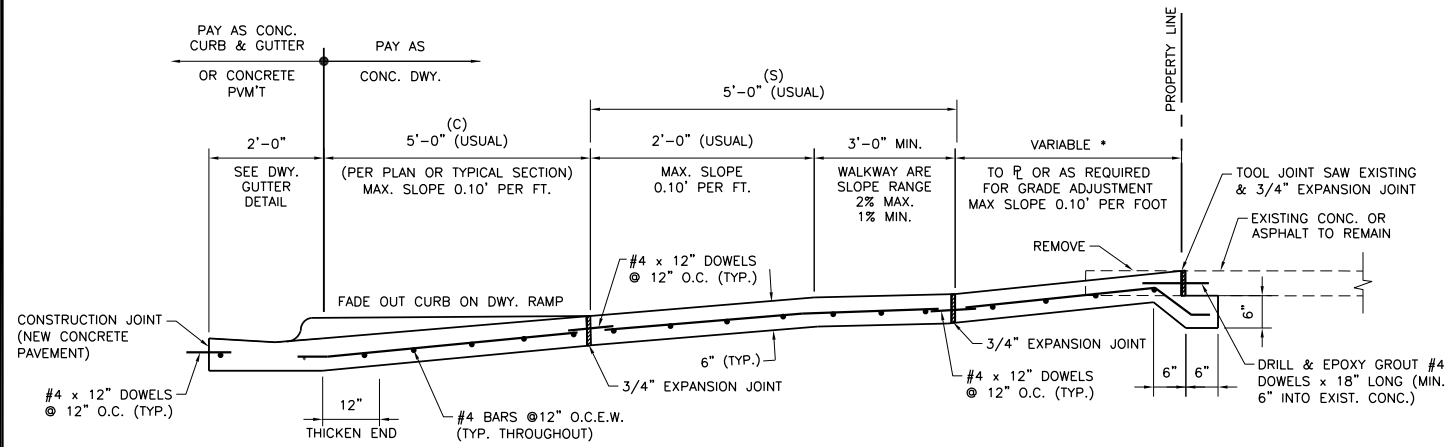

**SECTION
DRIVEWAY WITH DETACHED SIDEWALK**

NOT TO SCALE

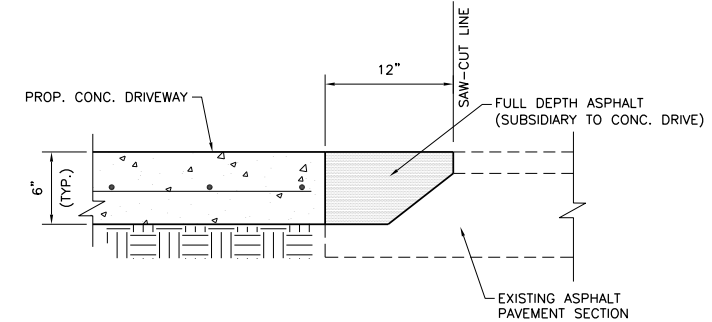

**CONC. DRIVEWAY TO
ASPHALT PAVEMENT TIE-IN DETAIL**

NOT TO SCALE

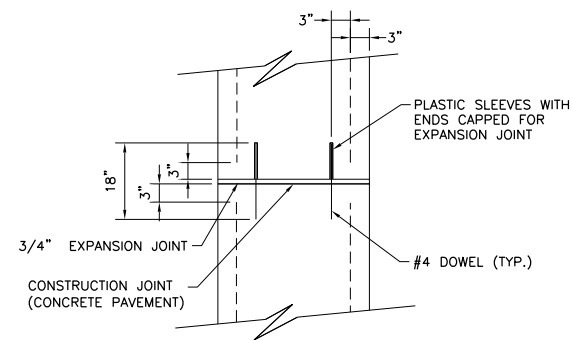

**PLAN
DRIVEWAY GUTTER**

NOT TO SCALE

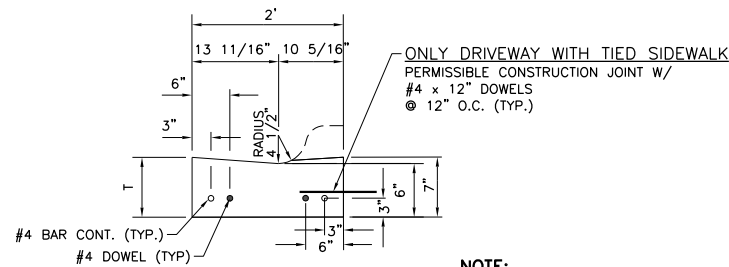

**SECTION
DRIVEWAY GUTTER**

NOT TO SCALE

NOTE:
T = THICKNESS OF CONCRETE PAVEMENT
OR CONCRETE CURB & GUTTER

| REVISION NO. | DATE | BY | DESCRIPTION |
|--------------|------|----|-------------|
| | | | |
| | | | |
| | | | |

**CITY OF CORPUS CHRISTI
TEXAS**
Department of Engineering Services

**CITY OF CORPUS CHRISTI
DRIVEWAY STANDARD DETAILS**

SHEET _____ of _____
RECORD DRAWING NO. _____
CITY PROJECT # _____

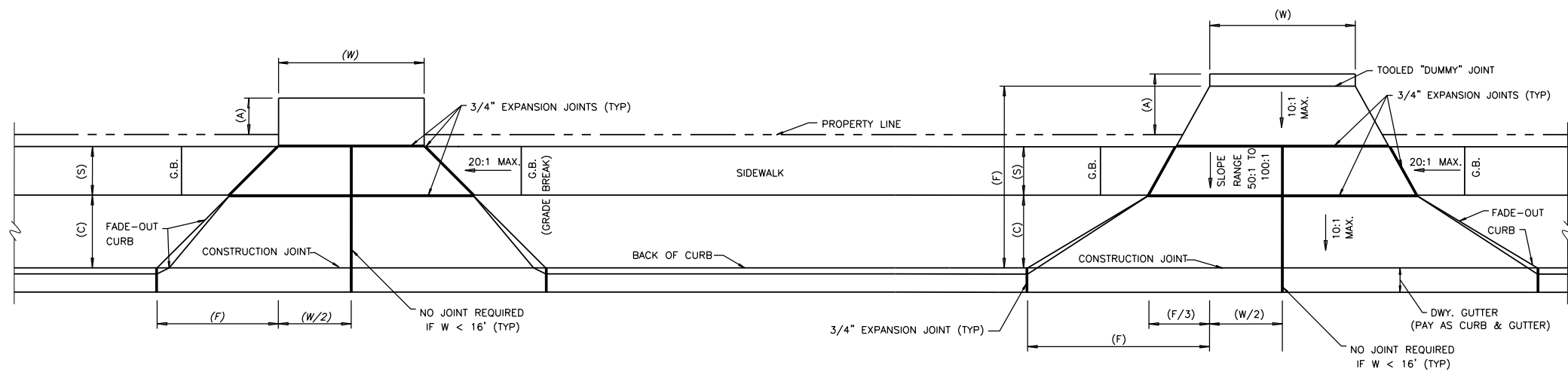

TYPE (C) DRIVEWAY
NOT TO SCALE

TYPE (S) DRIVEWAY
NOT TO SCALE

| STANDARD DRIVEWAY DIMENSION | | | |
|-----------------------------|----------------------|----------------------|---------|
| DWY. TYPE | F ^a (FT.) | W ^b (FT.) | M (FT.) |
| R | 5 | 10-30 | |
| C | 10 | 16-35 | |
| S | 15 | | |
| MRA | 5 | 10-30 | 5-10 |
| MRB | 5 | 10-30 | <5 |
| MCA | 10 | 16-35 | 10-20 |
| MCB | 10 | 16-35 | <10 |
| TR | 3 | 10-30 | |
| TS | 5 | <16 | |
| TMR | 3 | 10-30 | <6 |
| TMS | 5 | <16 | <10 |

^a VALUE OF F MAY BE CHANGED BY ENG.
^b RANGE OF NORMALLY ACCEPTABLE VALUES.

| LEGEND (DRIVE TYPE) | |
|---------------------|--|
| R | = RESIDENTIAL DRIVEWAY |
| C | = COMMERCIAL DRIVEWAY |
| S | = SPECIAL DRIVEWAY |
| MRA | = MULTIPLE RESIDENTIAL DRIVEWAY WITH DIVIDER CURB |
| MRB | = MULTIPLE RESIDENTIAL DRIVEWAY WITH NO DIVIDER CURB |
| MCA | = MULTIPLE COMMERCIAL DRIVEWAY WITH DIVIDER CURB |
| MCB | = MULTIPLE COMMERCIAL DRIVEWAY WITH NO DIVIDER CURB |
| TR | = TIED RESIDENTIAL DRIVEWAY |
| TS | = TIED SPECIAL DRIVEWAY |
| TMR | = TIED MULTIPLE RESIDENTIAL DRIVEWAY |
| TMS | = TIED MULTIPLE SPECIAL DRIVEWAY |

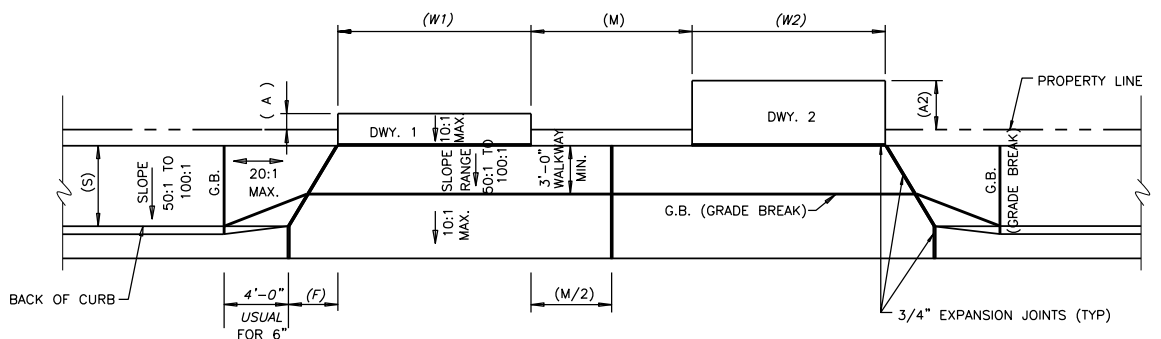

TYPES (TMR) & (TMS) DRIVEWAY
NOT TO SCALE

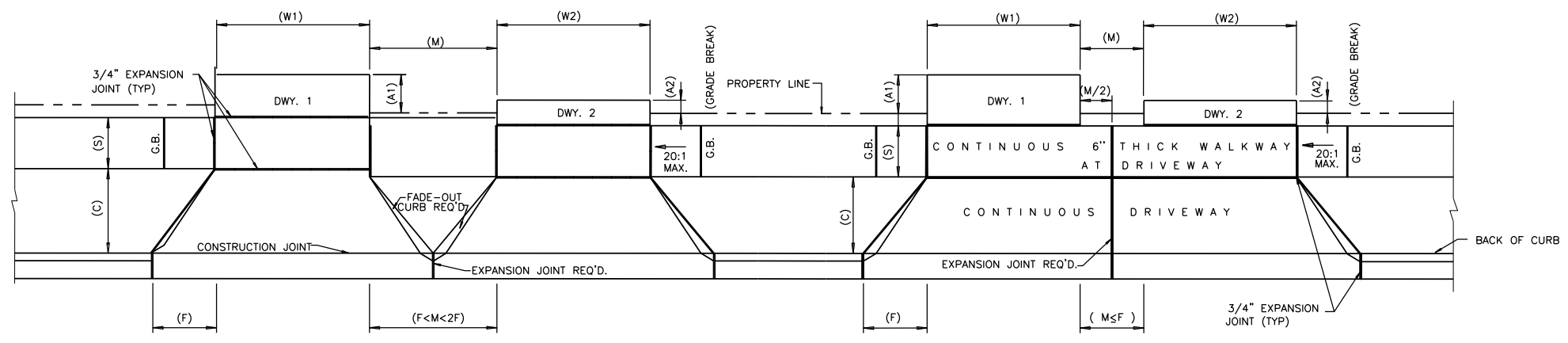

TYPES (MRA) & (MCA) DRIVEWAY
NOT TO SCALE

TYPES (MRB) & (MCB) DRIVEWAY
NOT TO SCALE

| REVISION NO. | DATE | BY | DESCRIPTION |
|--------------|------|----|-------------|
| | | | |
| | | | |
| | | | |

CITY OF CORPUS CHRISTI
 TEXAS
 Department of Engineering Services

CITY OF CORPUS CHRISTI
 DRIVEWAY STANDARD DETAILS

SHEET _____ of _____
 RECORD DRAWING NO. _____
 CITY PROJECT # _____